

Leon Theriot Lock Facts

furnished by Picciola & Associates, Inc.

New gate is designed to operate up to a +7.0 elevation



Width of each gate is 40 feet.
Weight of gates is 60 tons each.



Barge Structure weight is 2,952 tons
Measurements are 136'W x 55D x 30' 6"H
Opening for marine traffic is 60 ft. wide

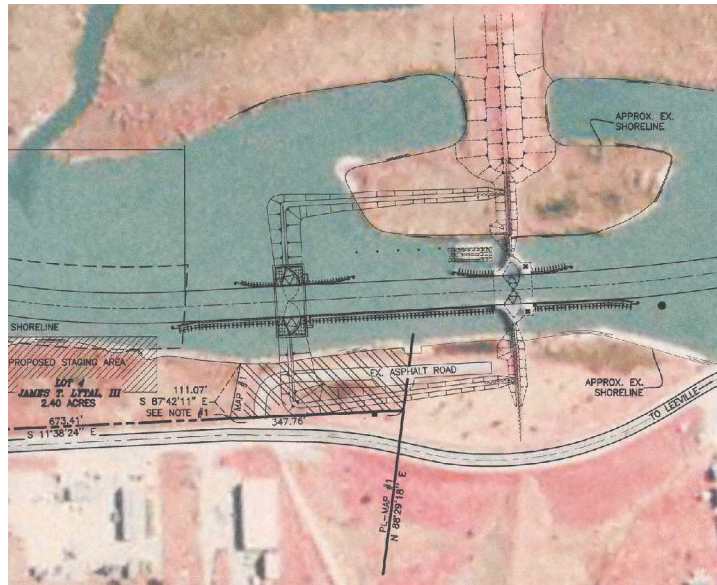

Distance between the two gates, which form the lock, is approximately 400 feet.